

MICRO SWITCHES

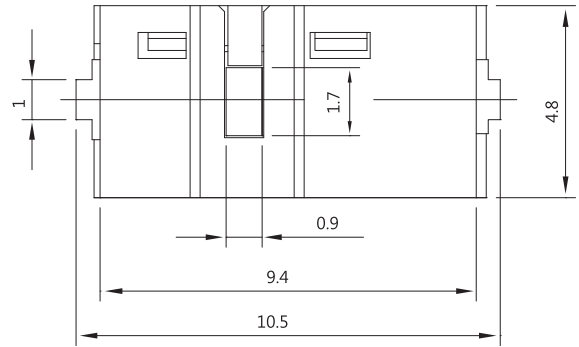

DIMENSIONS

Unless otherwise specified, a tolerance of $\pm 0.4\text{mm}$ applies to all dimensions.



DS SERIES

SPECIFICATIONS

Contact Resistance(initial)

Max. 800 m Ω

Measured by ohm meter - open voltage < 1VDC, driver current -100 mA

Insulation Resistance(at 250 VDC / minute)

Min. 100 M Ω

Dielectric Strength

250 VAC(50~ 60 Hz)

Operating Temperature Range

-40°C to 85°C (with no icing)

Vibration

10~55 Hz, displacement 0.75 mm(p-p)

Electrical Service Life

All rating Min. 3,000,000 operations

Electrical Operating Frequency

120 operations per minute

Mechanical Service Life

Min. 3,000,000 operations

Mechanical Operating Frequency

120 operations per minute

RATING

0.1A 125VAC, 0.1A 48VDC,

50mA 12VDC

APPLICATIONS

Mouse, Joystick

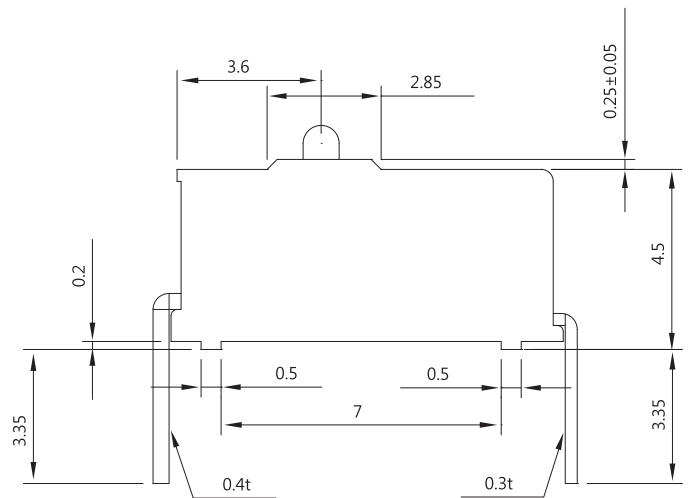

CONTACT CONFIGURATION

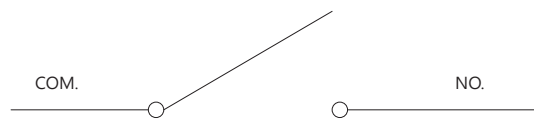

MOUNTING HOLES

P Type Terminal

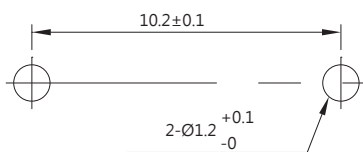

D Type Terminal

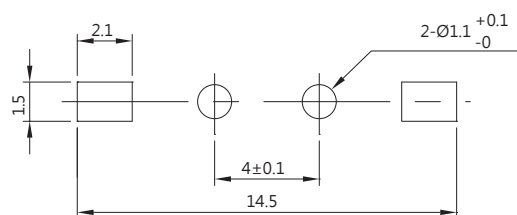

R · L Type Terminal

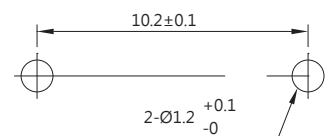

TERMINAL TYPES

P TYPE

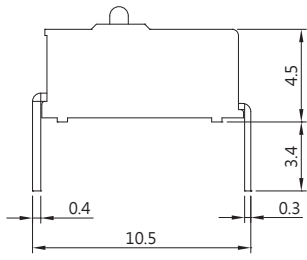

D TYPE

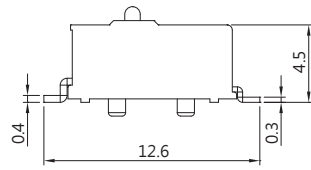

L TYPE

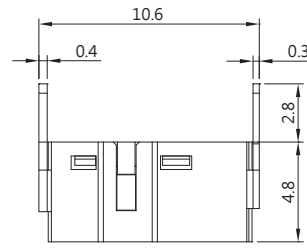

R TYPE

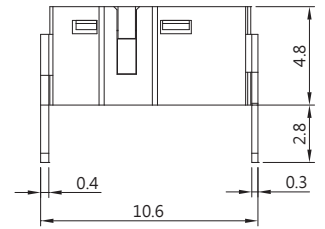

ORDERING INFORMATION

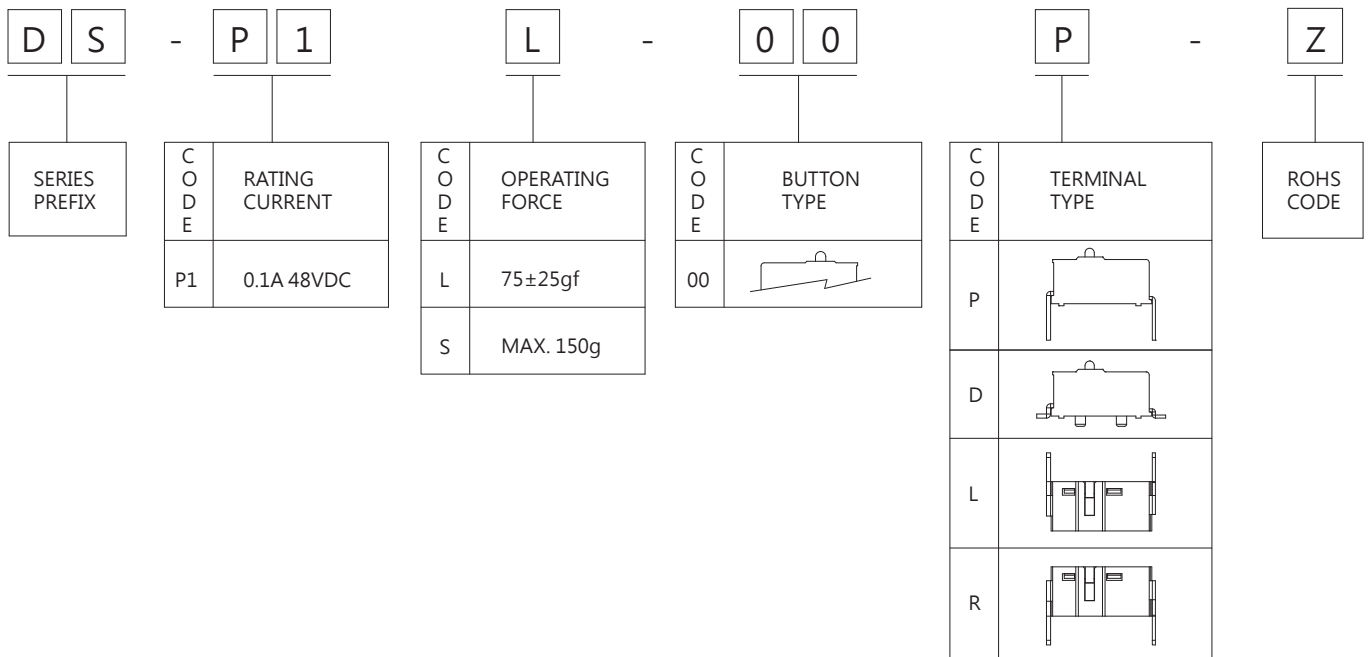

OPERATING CHARACTERISTICS

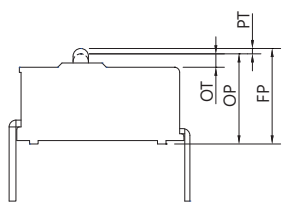
SWITCH TYPE	PART SUFFIX	OF (gf)	OP (mm)	PT Max. (mm)	OT Min. (mm)	MD Max. (mm)	RF Min. (gf)
DS-P1 □ -00P-Z		L	75±25	5.25±0.2	0.95	0.25	0.35
		S	Max.150				
							30