

Contacts of Changeover Timing		Non Shorting	
N	(A)	TERMINAL No. ② ③ OFF	9.8 ±0.5
	(B)	TERMINAL No. ① ② ON	8.8 ±0.5
	(C)	TOTAL TRAVEL	7.0 ±0.5

Contacts of Changeover Timing		Shorting	
S	(A)	TERMINAL No. ① ② ③ ON	10.2 ±0.5
	(B)	TERMINAL No. ② ③ OFF	8.4 ±0.5
	(C)	TOTAL TRAVEL	7.0 ±0.5

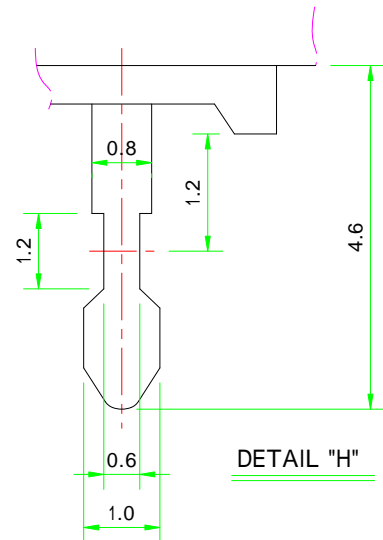

NOTE : - ±0.3

5									
4									
3									
2									
1									

NO.	DATE	REVISIONS		SIGN	NO	DESCRIPTION	SIZE	MAT'L	QTY	REMARK
		DRAWN	DESIGNED	APPROVED	SCALE	4/1	3RD	DWG NO.		
					UNIT	mm	ANGLE	IT - ML-12		
IN SUNG METAL CO.,LTD.							TITLE			
							MICRO LEVER SWITCH			