

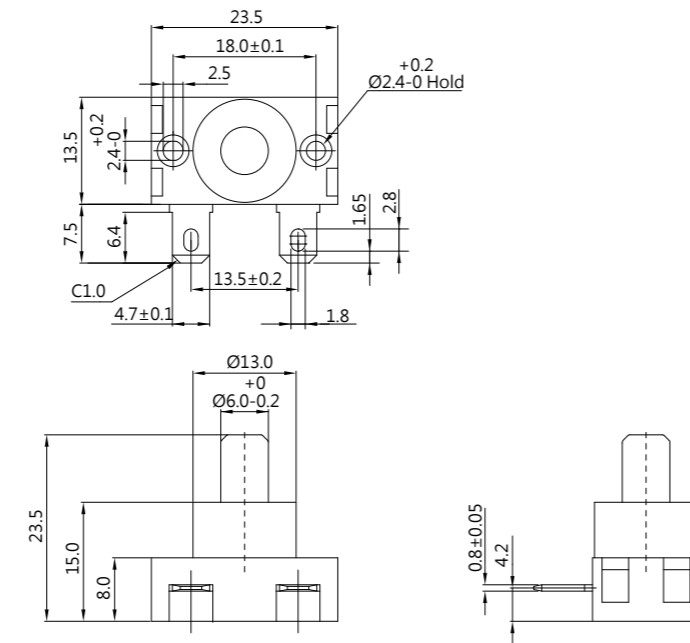

## DIMENSIONS

Unless otherwise specified, a tolerance of  $\pm 0.4\text{mm}$  applies to all dimensions.



## CONTACT CONFIGURATION

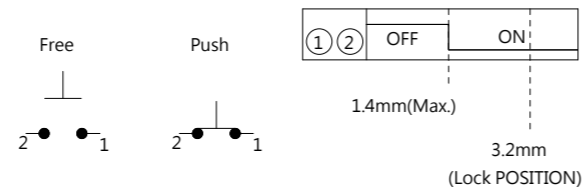

## CERTIFICATE INFORMATION

Model Name	UL	ENEC14
P8-10S	6A 250VAC 10A 125VAC (Temp 85°C) Min. 6,000 operations	7(4)A 250VAC, $\mu\text{T}85/551\text{E}4$

## TERMINAL TYPES

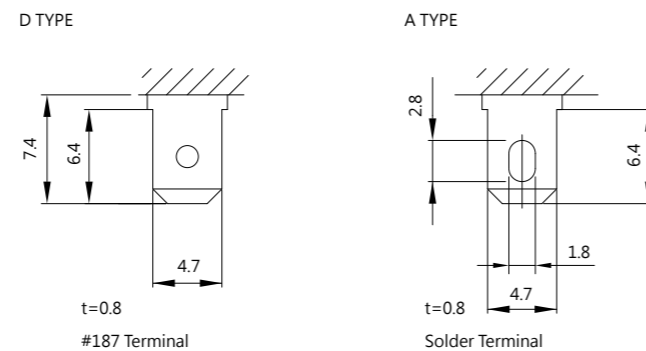

## P8 SERIES

### SPECIFICATIONS

#### Contact Resistance (initial)

Max. 50m $\Omega$   
Measured by ohm meter – open voltage < 1VDC, driver current -100mA

#### Insulation Resistance (at 500VDC/minute)

Min. 100M $\Omega$

#### Dielectric Strength

1000VAC (50~60Hz)

#### Storage Temperature Range

-25°C to 85°C (with no icing)

#### Storage Humidity

At 40°C, Max. 85% R.H

#### Operating Temperature Range

0°C to 85°C

#### Vibration

10~55HZ, displacement 0.75 mm (p-p)

#### Electrical Service Life

Min. 10,000 operations

#### Electrical Operating Frequency

10~30 operations per minute

### APPLICATIONS

Juice Maker, Blender, Food processor

## ORDERING INFORMATION

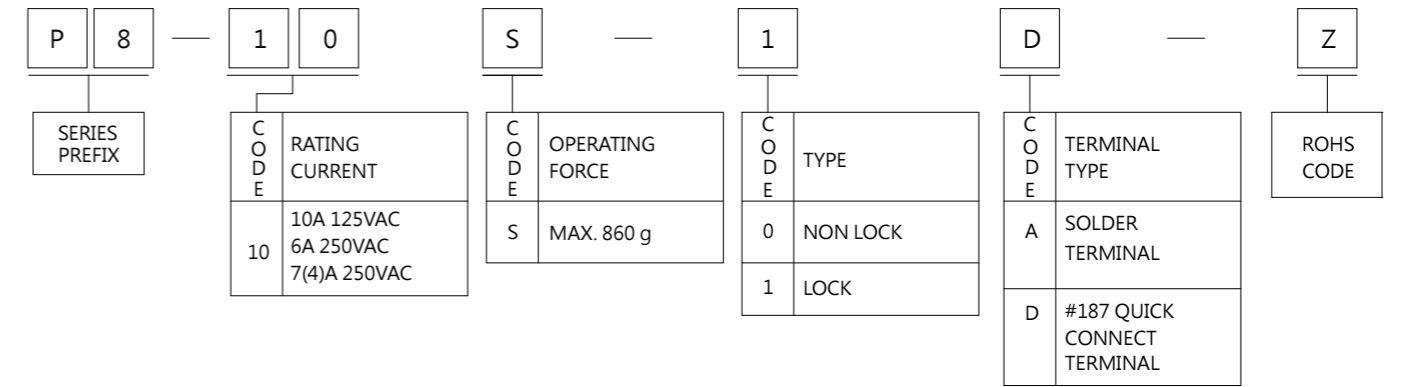

## OPERATING CHARACTERISTICS

SWITCH TYPE	PART SUFFIX	OF Max (gf)	FULL TRAVEL (mm)	LOCK TRAVEL (mm)
P8-10S-0 □ -Z		860gf	4.0 $\pm$ 0.5mm	---
P8-10S-1 □ -Z		860gf	4.0 $\pm$ 0.5mm	2.0 $\pm$ 0.5mm