

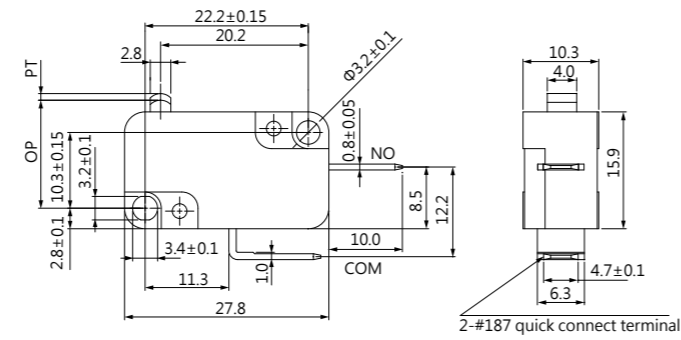

## DIMENSIONS

Unless otherwise specified, a tolerance of ±0.4mm applies to all dimensions.



## TERMINAL TYPES

### D TYPE

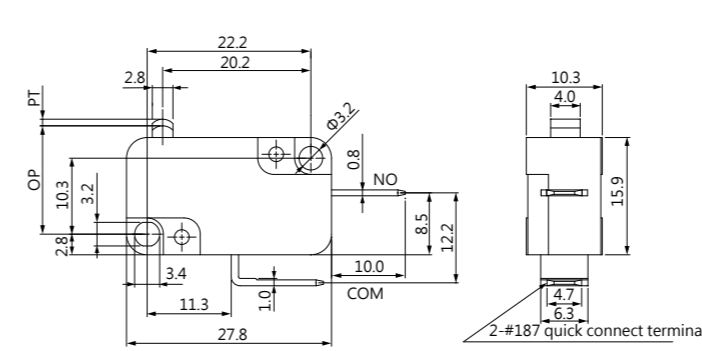

### G TYPE

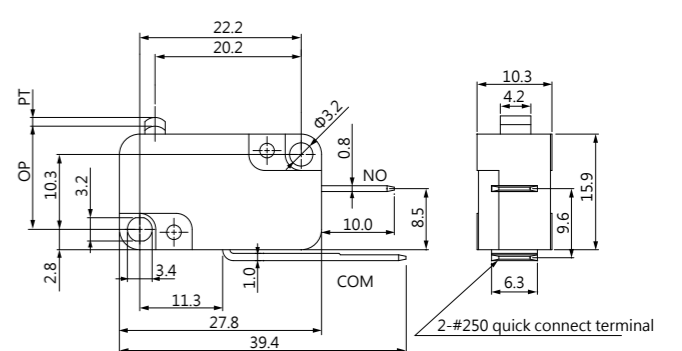

## CONTACT CONFIGURATION

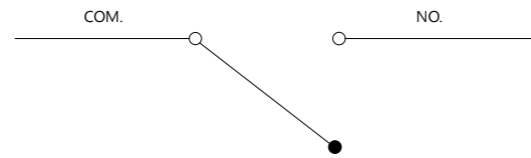

## MOUNTING HOLES

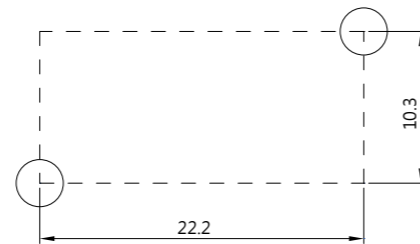

## CERTIFICATE INFORMATION

Model Name	UL, cUL	ENEC14
V3-10	10.1A or 1/2HP 125/250VAC (Temp:100°C) Min. 6,000 operations	10(4)A 125/250VAC, T100 1E4
V3-16	16A or 1/2HP 125/250VAC (Temp:125°C) Min. 6,000 operations	16(4)A 125/250VAC, T125 1E4
V3-20	20.1A or 1/2HP 125/250VAC (Temp:100°C) Min. 6,000 operations	20.1A 125/250VAC, T125, 1E4 10.1(8)A 125/250VAC, μT125, 1E4
V3-25	25A or 1/2HP 125/250VAC (Temp:100°C) Min. 6,000 operations	25.1A 125/250VAC, T125, 1E4 10.1(8)A 125/250VAC, μT125, 1E4

## THE SELECTION OF RATING & FORCE

MODEL	Rating	L	S	H
V3	10A, 10(4) A	*	*	*
	16A, 16(4) A	*	*	*
	20.1 A	*	*	*
	25 A	*	*	*
	10.1(8)A	*	*	*

NOTE : The Symbol " \* " to represent the result is accepted

## V3 SERIES

( Full-Disconnection – Gap > 3mm )

### SPECIFICATIONS

#### Contact Resistance(initial)

Max. 30 mΩ  
Measured by ohm meter - open voltage < 1VDC, driver current -100 mA

#### Insulation Resistance (at 500 VDC / minute)

Min. 100 MΩ

#### Dielectric Strength

1500 VAC(50~ 60 Hz)

#### Storage Temperature Range

-25°C to 85°C (with no icing)

#### Storage Humidity

At 40°C, Max. 85% R.H

#### Operating Temperature Range

-40°C to 125°C (with no icing)

#### Vibration

10~55 Hz, displacement 0.75 mm(p-p)

#### Electrical Service Life

All ratings - Min. 10,000 operations

#### Electrical Operating Frequency

All ratings - 10~30 operations per minute

#### Mechanical Service Life

Min. 5,000,000 operations

#### Mechanical Operating Frequency

120 operations per minute

### APPLICATIONS

Joystick, TV game, Time recorder, Air conditioner, Food processor, Juice maker, Alarm, Mixer, Shredder machine.

### ORDERING INFORMATION

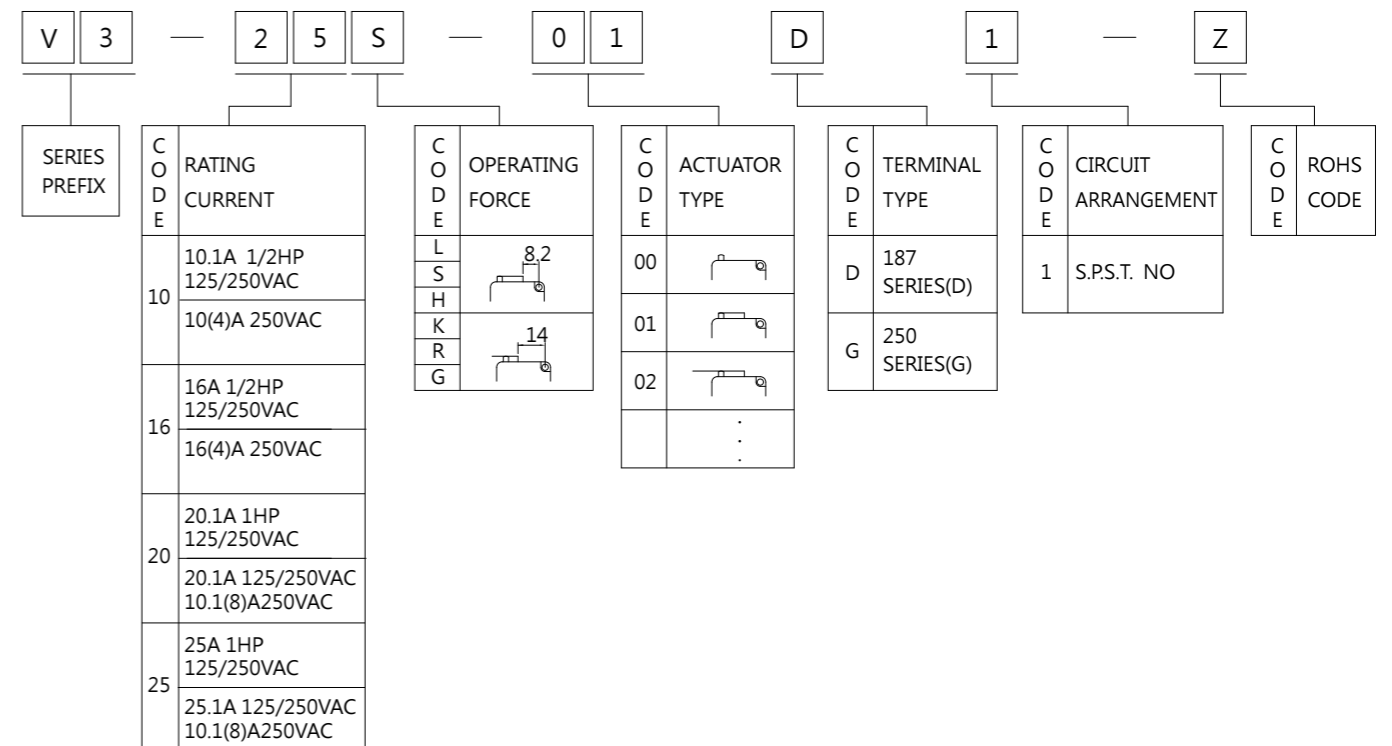

OPERATING CHARACTERISTICS

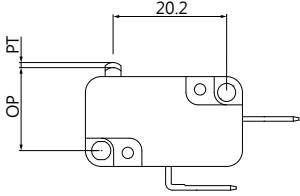
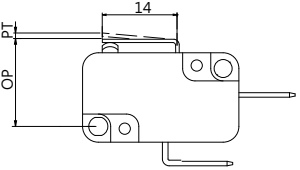
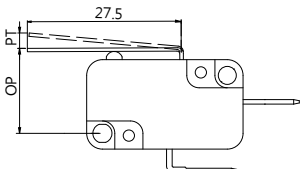
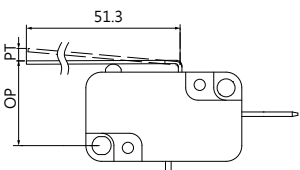
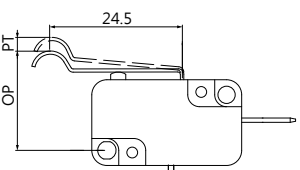
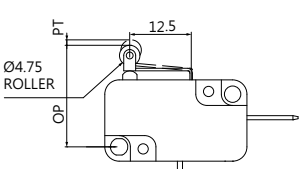
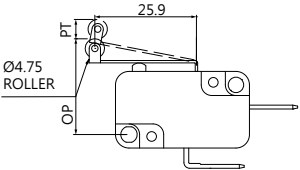
SWITCH TYPE	PART SUFFIX	OF Max. (gf)			OP (mm)	PT Max. (mm)	OT Min. (mm)	MD Max. (mm)
		L	S	H				
		K	R	G				
V3- □□□ -00 □□ -Z		190	510	842	14.4±0.5	1.90	0.7	1.20
		-	-	-	-	-	-	-
V3- □□□ -01 □□ -Z		190	510	728	15.0±0.8	2.40	0.5	1.40
		135	295	377	15.0±1.2	4.10	0.90	1.70
V3- □□□ -02 □□ -Z		100	260	374	15.0±1.5	4.80	1.0	2.70
		80	150	194	15.0±2.3	8.0	1.70	3.30
V3- □□□ -03 □□ -Z		52	140	203	15.0±2.80	8.9	1.80	5.10
		46	80	106	15.0±4.30	15.0	3.10	6.20
V3- □□□ -04 □□ -Z		108	290	419	18.4±1.3	4.30	0.90	2.40
		88	170	218	18.4±2.0	7.20	1.50	2.90
V3- □□□ -05 □□ -Z		190	510	842	20.4±0.7	2.20	0.40	1.20
		145	330	422	20.4±1.0	3.70	0.80	1.50
V3- □□□ -06 □□ -Z		102	275	397	20.4±1.4	4.50	0.90	2.60
		84	160	206	20.4±2.2	7.60	1.60	3.10