

MICRO SWITCHES

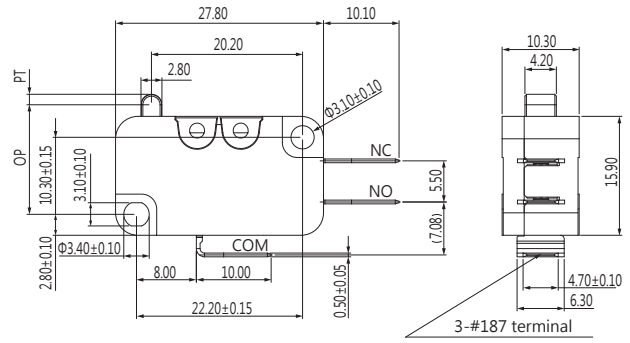

DIMENSIONS

Unless otherwise specified, a tolerance of $\pm 0.4\text{mm}$ applies to all dimensions.



CONTACT CONFIGURATION

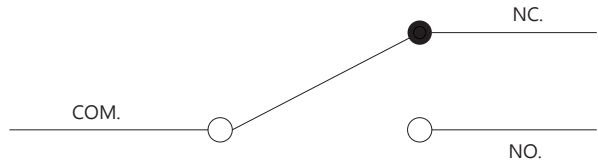

MOUNTING HOLES

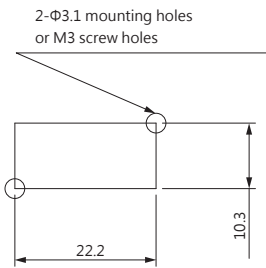

CERTIFICATE INFORMATION

Model Name	UL, cUL	ENEC15
VA2-P1	0.1A 125/250VAC (Temp:125°C) Min. 10,000 operations	0.1A 125/250VAC, μT125 1E4
VA2-06	6A 125/250VAC (Temp:125°C) Min. 10,000 operations	6A 125/250VAC, μT125 1E4
VA2-10	10A 125/250VAC (Temp:125°C) Min. 10,000 operations	10(4)A 125/250VAC, μT125, 1E4
VA2-16	16A 125/250VAC (Temp:125°C) Min. 10,000 operations	16(4)A 125/250VAC, μT125, 1E4
VA2-20	20A 125/250VAC (Temp:125°C) Min. 10,000 operations	20A 125/250VAC, μT125, 1E4

VA2 SERIES

SPECIFICATIONS

Contact Resistance(initial)

Max. 100 mΩ

Measured by ohm meter - open voltage < 1VDC, driver current -100 mA

Insulation Resistance (at 500 VDC / minute)

Min. 100 MΩ

Dielectric Strength

1500 VAC(50~ 60 Hz)

Operating Temperature Range

-40°C to 125°C (with no icing)

Vibration

10~55 Hz, displacement 0.75 mm(p-p)

Electrical Service Life

Min. 10,000 operations

Electrical Operating Frequency

10~30 operations per minute

Mechanical Service Life

Min. 1,000,000 operations

Mechanical Operating Frequency

120 operations per minute

APPLICATIONS

Joystick, TV Game, Time Recorder, Air Conditioner, Food Processor, Juice Maker, Alarm, Mixer, Shredder Machine

THE SELECTION OF RATING & FORCE

MODEL	Rating	B (Max. 18gf)	D (Max. 45gf)	N (Max. 75gf)	L (Max. 110gf)	S (Max. 170gf)	H (Max. 230gf)	Q (Max. 330gf)
VA2	0.1A	*	*	*	*	*	*	*
	6A		*	*	*	*	*	*
	10A			*	*	*	*	*
	16A				*	*	*	*
	20A					*	*	*

NOTE : The Symbol " * " to represent the result is accepted

TERMINAL TYPES

A TYPE

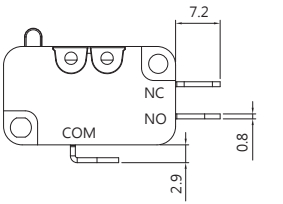

STANDARD

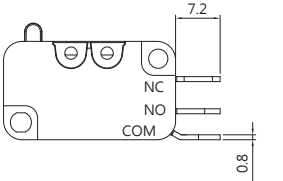

SIDE OUT

B TYPE

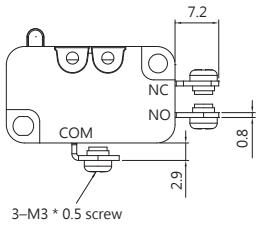

STANDARD

C TYPE
250 terminal
(6.3x0.8)

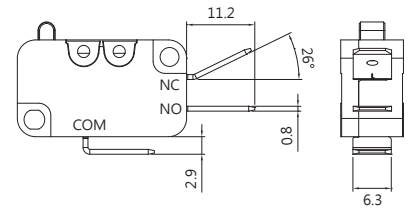

STANDARD

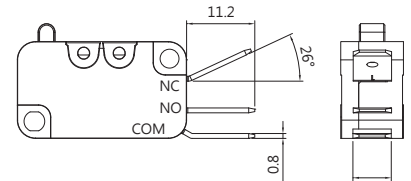

SIDE OUT

D TYPE
187 terminal
(4.7x0.5)

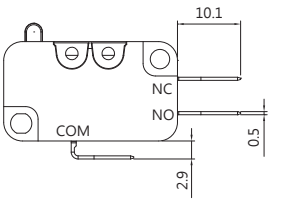

STANDARD

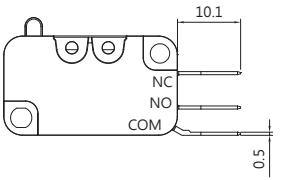

SIDE OUT

E TYPE
250 terminal
(6.3x0.8)

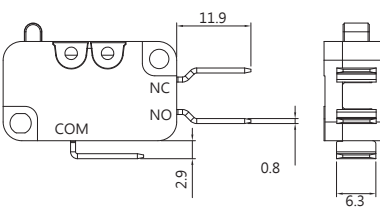

STANDARD

F TYPE
250 terminal
(6.3x0.8)

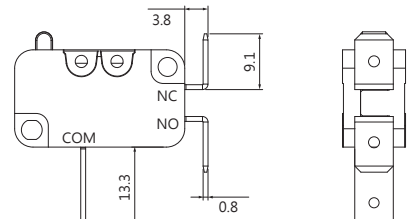

STANDARD

H TYPE
187 terminal
(4.7x0.8)

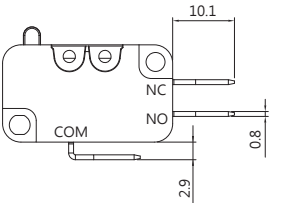

STANDARD

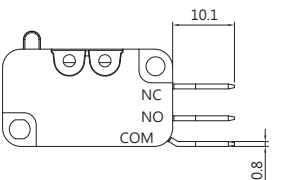





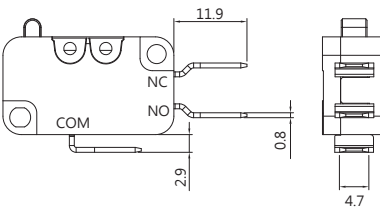





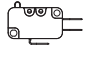



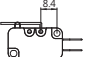

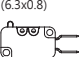
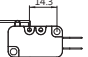

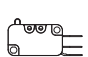

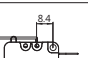
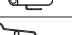

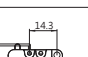

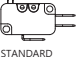

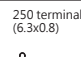
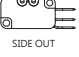











SIDE OUT

I TYPE
187 terminal
(4.7x0.8)



STANDARD

ORDERING INFORMATION

V	A	2	-	1	6	S	0		-	0	0	D	0	-	Z
SERIES PREFIX	C O D E	RATING CURRENT	C O D E	OPERATING FORCE	C O D E	EXTERIOR TYPE	C O D E	MOUNTING HOLES TYPE	C O D E	ACTUATOR TYPE	C O D E	TERMINAL TYPE	C O D E	CIRCUIT ARRANGEMENT	ROHS CODE
	P1	0.1A 125/250VAC	Q	HEAVIER	0	 STANDARD TERMINAL NO ACTUATOR	A	 MOUNTING HOLES $\Phi 3.1$	00		A	 STANDARD	E	0	T125 S.P.T
	06	6A 125/250VAC	H	HEAVY	1	 STANDARD TERMINAL ACTUATOR AWAY BUTTON			01			 STANDARD	1	T125 S.P.S.T NO	
	10	10A;10(4)A 125/250VAC	S	STANDARD	2	 STANDARD TERMINAL ACTUATOR NEAR BUTTON			02			 STANDARD	2	T125 S.P.S.T NC	
	16	16A;16(4)A 125/250VAC	L	LIGHT	3	 SIDE OUT TERMINAL NO ACTUATOR			03			 STANDARD			
	20	20A 125/250VAC			4	 SIDE OUT TERMINAL ACTUATOR AWAY BUTTON			04			 STANDARD	H		
					5	 SIDE OUT TERMINAL ACTUATOR NEAR BUTTON			05			 STANDARD	I		
									06			 STANDARD			
												 SIDE OUT			
												 STANDARD			
												 STANDARD			
												 STANDARD			
												 STANDARD			
												 STANDARD			
												 STANDARD			
												 STANDARD			
												 STANDARD			
												 STANDARD			
												 STANDARD			
												 STANDARD			
												 STANDARD			
												 STANDARD			
												 STANDARD			
												 STANDARD			
												 STANDARD			
												 STANDARD			
												 STANDARD			
												 STANDARD			
												 STANDARD			
												 STANDARD			

OPERATING CHARACTERISTICS

SWITCH TYPE	PART SUFFIX	OF Max. (gf)							OP (mm)	PT Max. (mm)	OT Min. (mm)	MD Max. (mm)
		B	D	N	L	S	H	Q				
VA2- □□□ 0-00D0-Z		18	45	75	110	170	230	330	14.7±0.5	1.72	0.8	0.4
VA2- □□□ 1-01D0-Z		18	45	75	110	170	230	330	15.3±0.5	2.8	0.6	0.5
VA2- □□□ 2-01D0-Z		8	27	43	50	85	120	175	15.3±1.1	5.2	1.55	0.9
VA2- □□□ 1-02D0-Z		8	22	37	50	86	125	180	15.3±1.5	5.9	1.6	1.0
VA2- □□□ 2-02D0-Z		5	16	25	30	51	65	90	15.3±2.3	9.7	3.1	2.2
VA2- □□□ 1-03D0-Z		6	13	25	30	49	70	120	15.3±2.5	9.3	-	2.1
VA2- □□□ 2-03D0-Z		4	8	15	20	30	35	50	15.3±4.3	16.2	-	3.5
VA2- □□□ 1-04D0-Z		10	28	43	65	110	140	205	18.7±1.5	5.5	1.4	1.1
VA2- □□□ 2-04D0-Z		7	16	24	35	56	70	100	18.7±2.1	8.7	3.2	1.7
VA2- □□□ 1-05D0-Z		20	55	80	110	170	230	330	20.7±0.8	2.7	0.6	0.45
VA2- □□□ 2-05D0-Z		8	35	55	70	100	120	175	20.7±1.1	4.65	1.4	0.8
VA2- □□□ 1-06D0-Z		8	30	45	65	100	125	180	20.7±1.5	4.2	1.6	1.25
VA2- □□□ 2-06D0-Z		7	20	30	40	51	65	90	20.7±2.2	9.3	2.8	1.8